

MIASA ZUERA

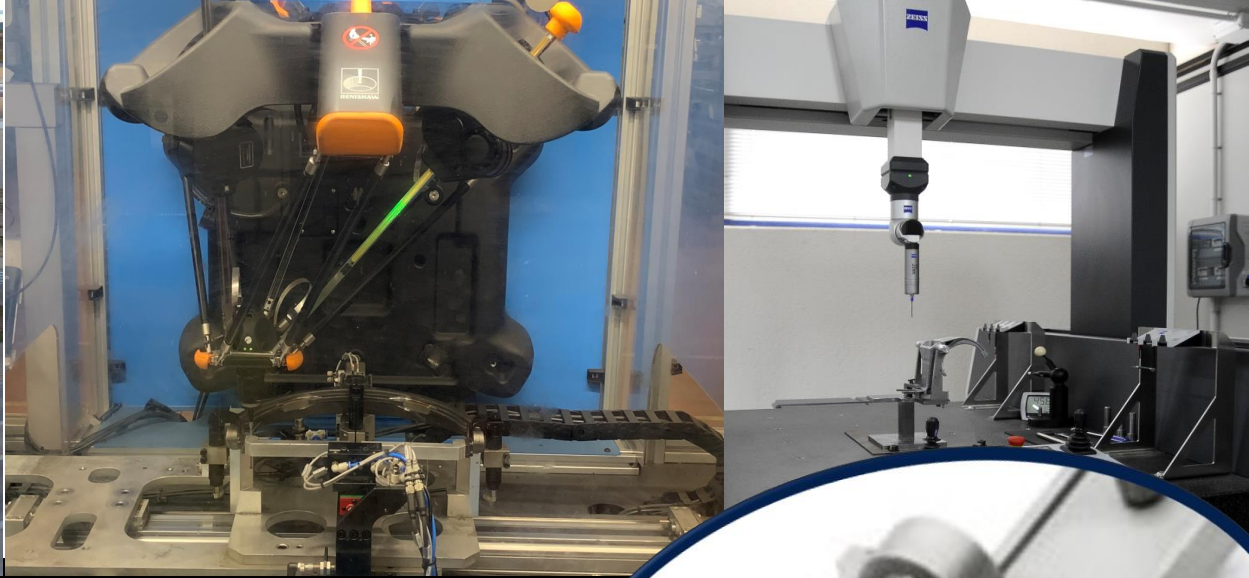



Overview presentation

PART 1	ABOUT MIASA ZUERA...
PART 2	FIGURES REPRESENTING MIASA ZUERA
PART 3	OUR KNOWLEDGE
PART 4	OUR PROCESS
PART 5	OUR ASSOCIATED CAPABILITIES
PART 6	OUR MACHINES / INSTALLATION
PART 7	OUR CUSTOMERS
PART 8	ABOUT F2J INDUSTRY

ABOUT F2J PAMPLONA...



- 1968** MIASA was founded in February 29th 1968 in Pamplona (Navarra).
The activity was the machining of copper based and aluminium based castings for the different industrial sector : Electrical, railways, irrigation...
- 1992** MIASA essentially focused in the development and production of automotive components.
- 2007** Internationalization of the company. MIASA set up a factory in Indiana (USA) to produce local transmission components.

- 2017** Establishment of a new Manufacturing location in Spain : MIASA ZUERA
- 2018** MIASA starts diversification strategy.
- 2023** MIASA Group is purchased by F2J Industry in January 2023

FIGURES REPRESENTING F2J PAMPLONA



TURNOVER 2024 : 23 M €

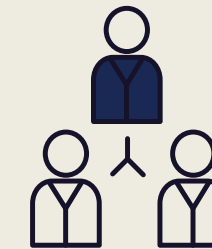

95 EMPLOYEES



6 000 M2 FACTORY SURFACE

OUR KNOWLEDGE

DESIGN

CAD

Siemens NX (Unigraphics).
Compatibility with other softwares

CUSTOMER
INPUT

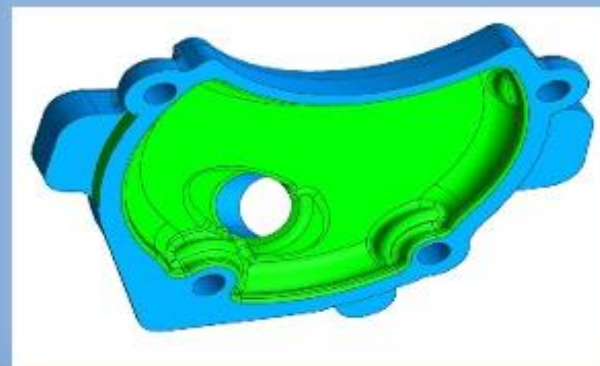

SIMULATION

FEA

MSC PATRAN NASTRAN, MARC

CUSTOMER
INPUT

MIASA
OUTPUT

- Loads
- Boundary conditions, if customer prefers to fix them.
- Finite element analysis
- Conclusions

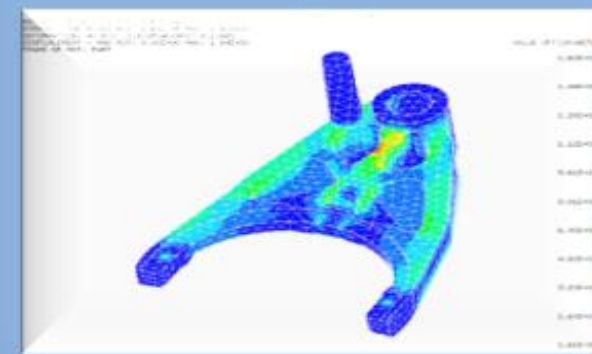

CASTING FLOW SIMULATION

QUIKCAST

MIASA OUTPUT

- Flow simulation is made before mould manufacturing
- We have extensive experience in the use of advanced simulation methods with proven success

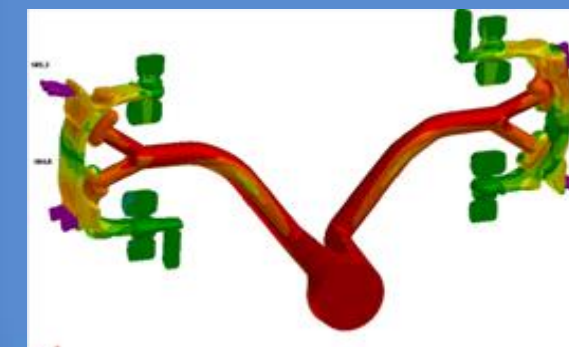

TESTING

HYDROPULSE TEST MACHINE

LOAD CELLS: 10 kN & 50 kN

+

CLIMATIC CHAMBER

-30°C & 150°C (-22°F / 302°F)

PADS WEAR TEST FOR THE FORKS

LOAD CELLS: 10 kN & 50 kN

- Fatigue / durability
- Static load tests, breakage
- Stiffness
- Pads wear test for the Forks



OUR KNOWLEDGE

In our facilities we are able to **develop, simulate, prototype, validate and industrialize** our products.

In cooperation with our customers, new solutions focused on weight and cost reduction resulted in:

- **New materials.**
- **New functions.**
- **New or adaptable assemblies.**
- **Optimization**
- **Quality assurance.**
- **Durability.**

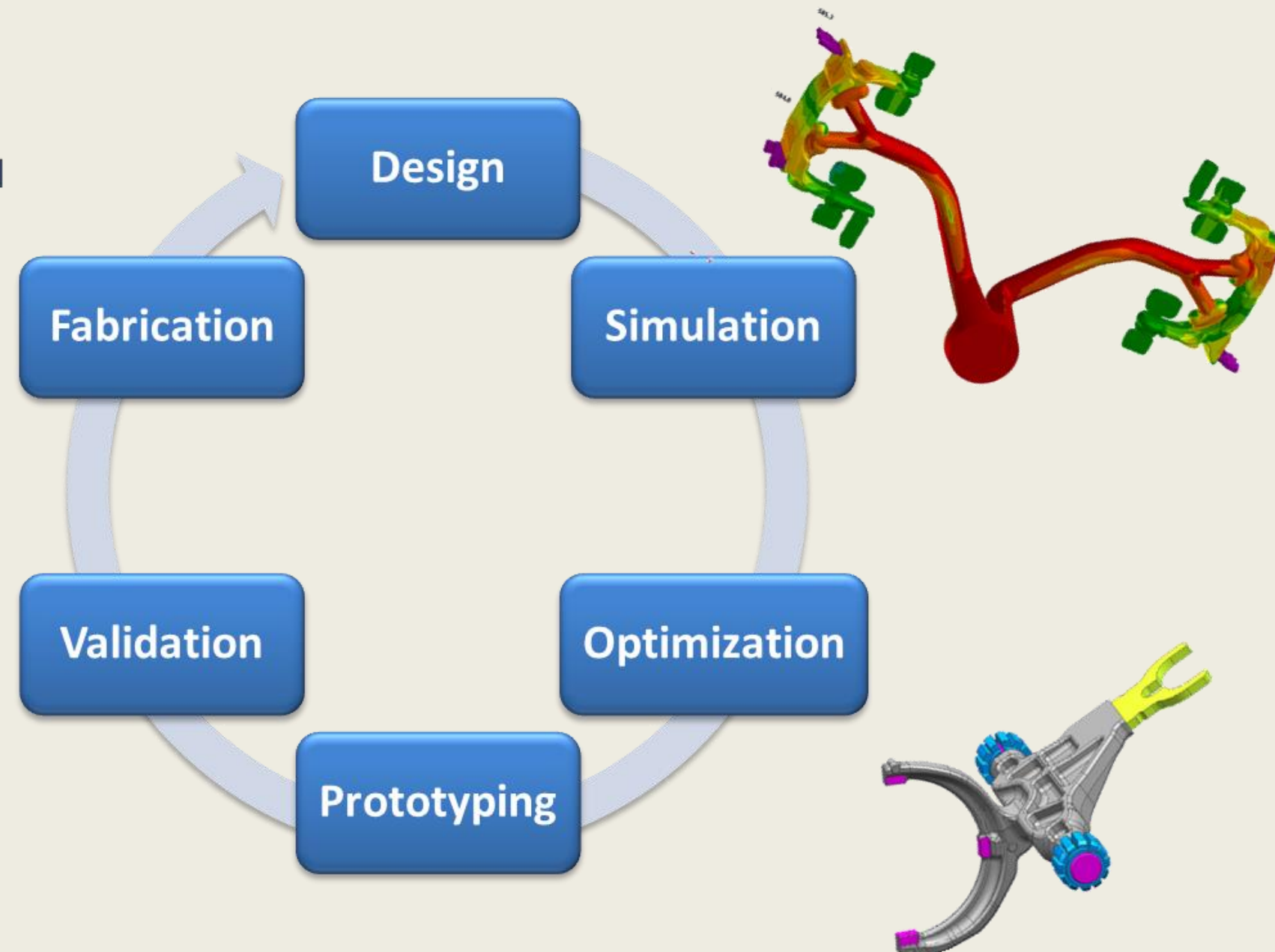
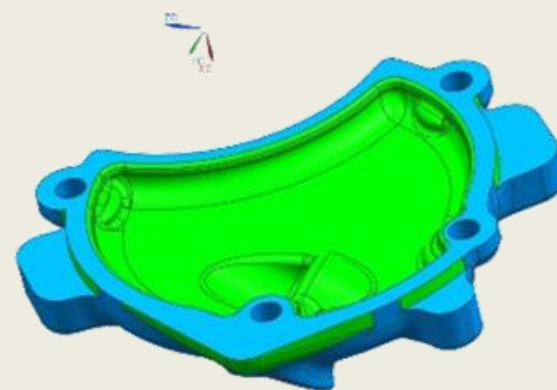

Our process

Machining

- Machining in CNC
- Machining in lathe
- Plastic overmoulding
- Welding
- Induction hardening
- Shafts grinding
- Assembly of components
- In line dimensioning control
- Washing machines
- Leakage testing in production



Our Parts



Transmission shift forks for passenger cars



Our parts



Transmission shift for trucks



Our Parts

Brackets and levers

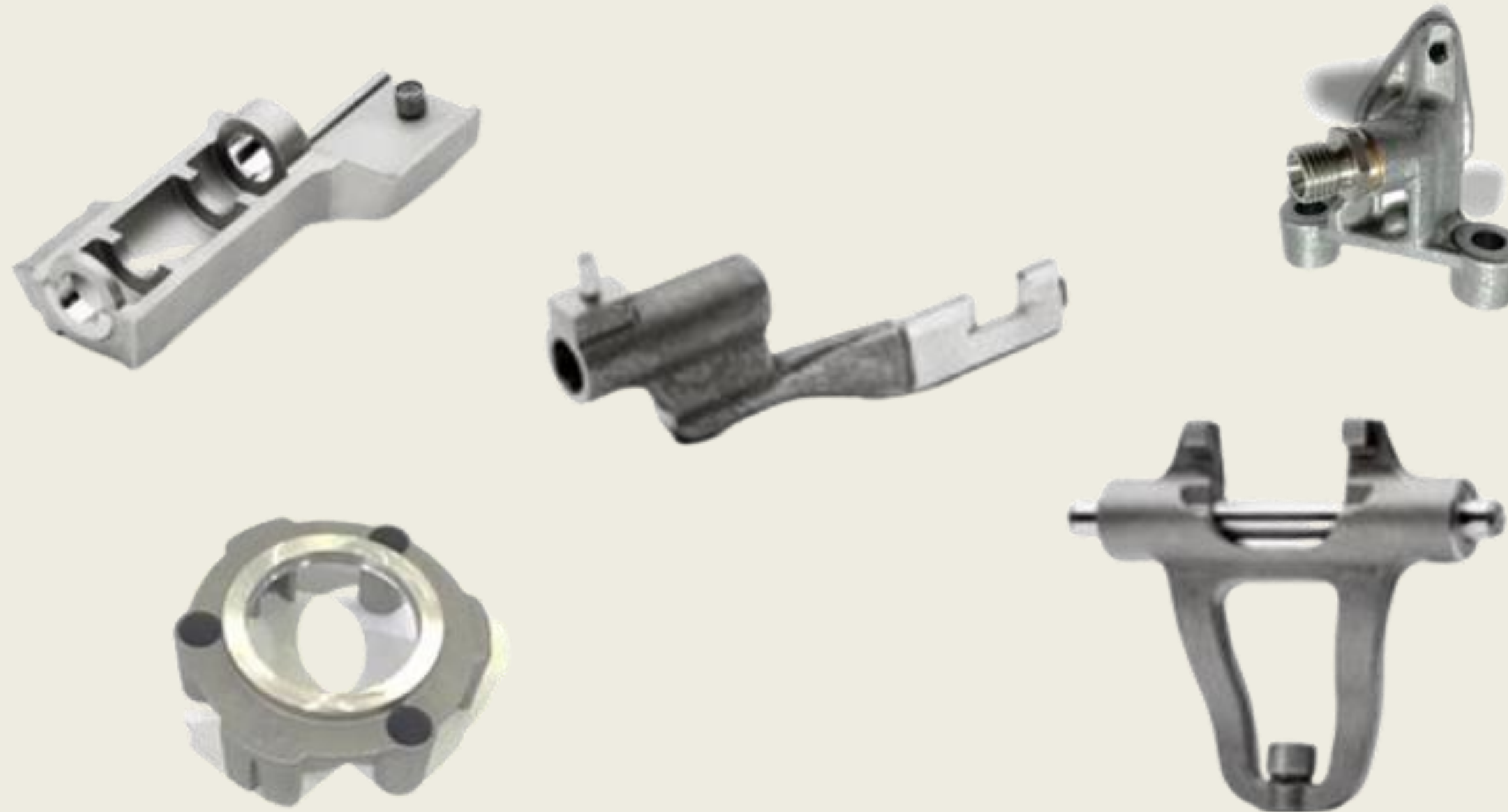

Our parts

Shafts



Our Parts

Aluminium housings



Our Associated Capabilities

SHAFTS INDUCTION
HARDENING



GRINDING



WASHING



Our Associated Capabilities



WELDING

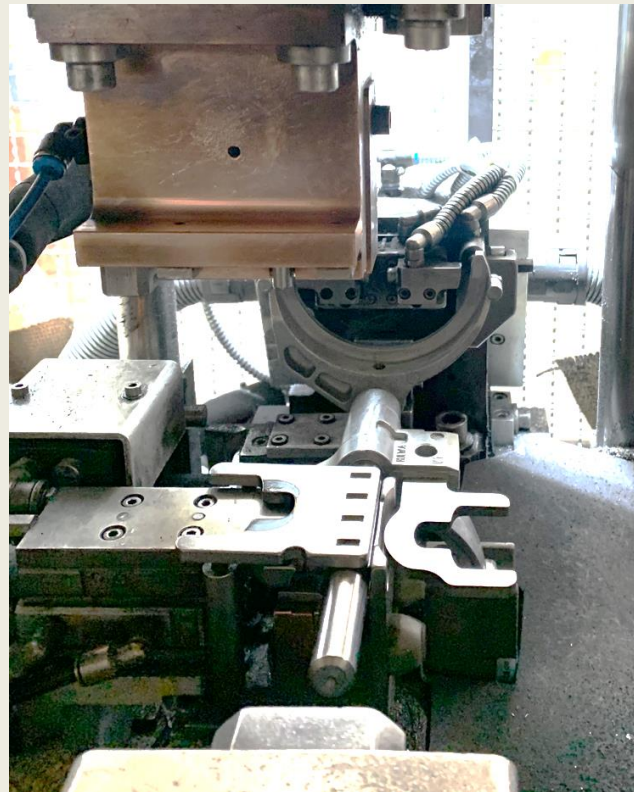

DIMENSIONAL CONTROL IN PRODUCTION

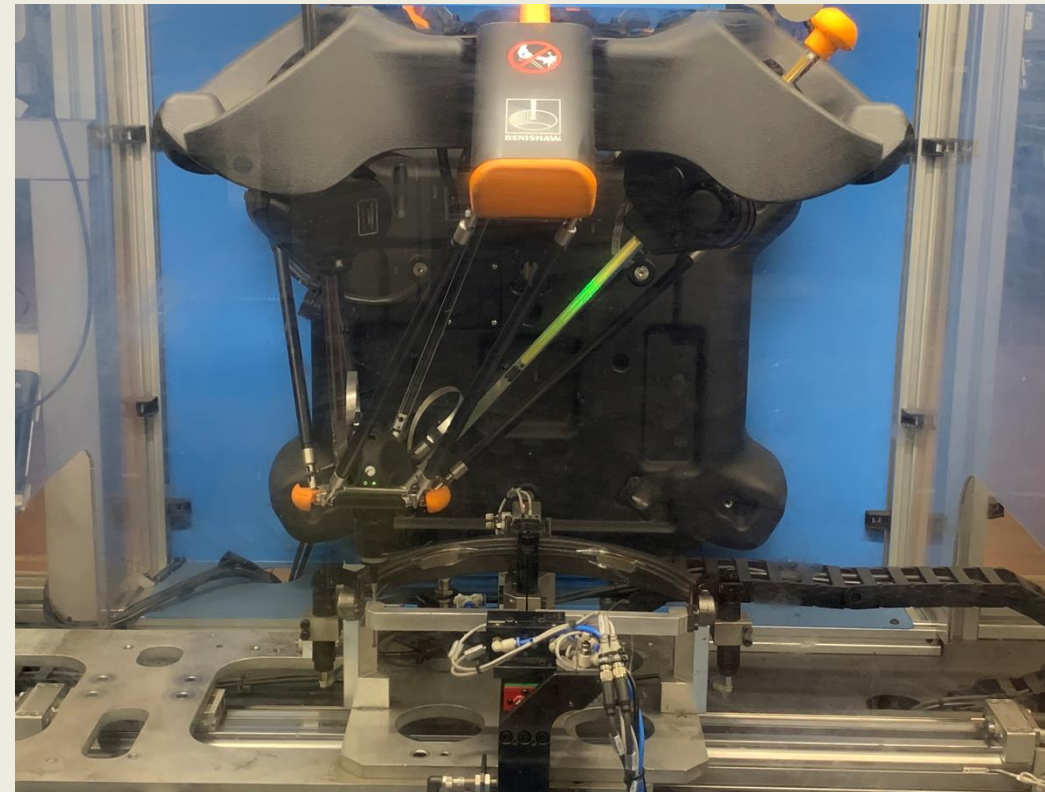

LEAKAGE TEST

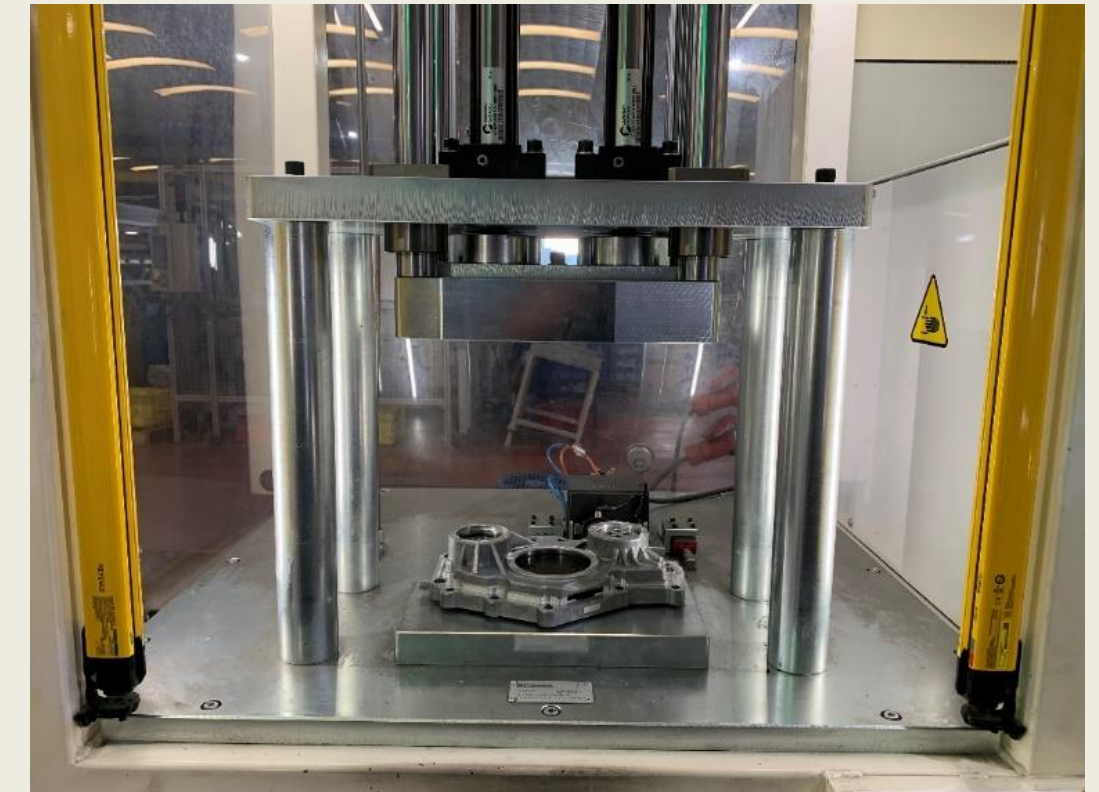

Our Machines/Installations

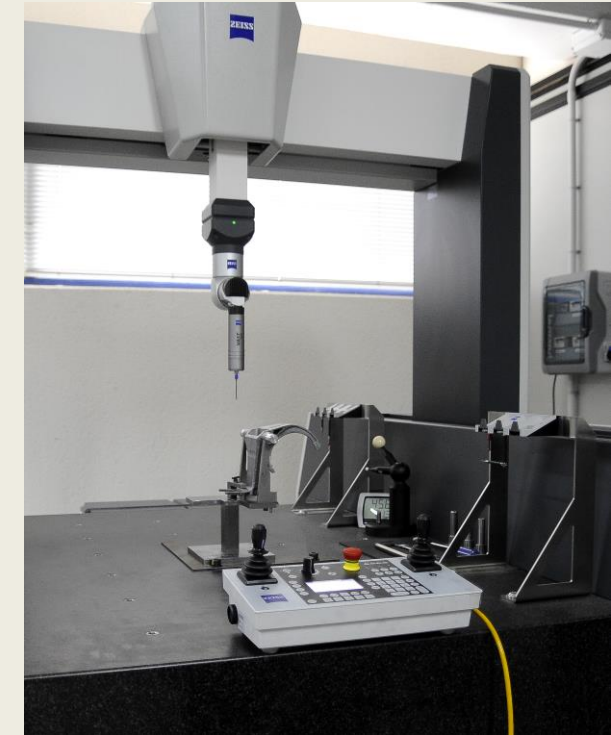

Our Customers



ABOUT F2J INDUSTRY...



Turnover: 195 M€

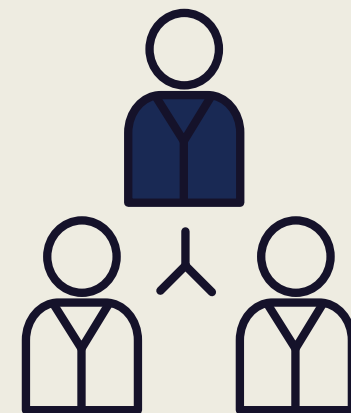

1 650 employees



4 plants in France
1 plant in Poland
3 plants in Argentina
1 plant in Brazil
2 plants in Spain
1 plant in USA



<http://f2jindustry.com>

<https://www.linkedin.com/company/f2jindustry>



F2J INDUSTRY

INDUSTRIAL GROUP OF COMPANIES



USA



Indiana
Turnover: 8,8 M € / 45 Employees
5.000 m² Factory surface
Certified IATF 16949

ARGENTINA



Córdoba
Turnover: 29,4 M € / 230 Employees
12.354 m² Factory Surface
Certified IATF 16949 and ISO 14001



Córdoba
Turnover: 25,8 M € / 330 Employees
16.000 m² Factory surface
Certified IATF 16949 and ISO 14001



Buenos Aires
Turnover: 5,4 M € / 135 Employees
12.000 m² Factory surface
Certified: IATF 16949:2016 and ISO 14001

BRAZIL



São Paulo
Turnover: 37 M € / 395 Employees
22.000 m² Factory surface
Certified IATF 16949

SPAIN



Pamplona
Turnover: 6,5 M € / 34 Employees
7.000 m² Factory surface
Certified IATF 16949 and ISO 14001



Zuera
Turnover: 23 M € / 95 Employees
6.000 m² Factory surface
Certified IATF 16949 and ISO 14001

POLAND



Radom
Turnover: 5,5 M € / 40 Employees
3.200 m² Factory surface
Certified IATF 16949 and ISO 14001

FRANCE



Auxi-le-Château
Turnover: 9,5 M € / 91 Employees
26.000 m² Factory surface
Certified IATF 16949



Chaumont
Turnover: 10,9 M € / 66 Employees
9.700 m² Factory surface
Certified IATF 16949 and ISO 14001



Bessines-Sur-Gartempe
Turnover: 13 M € / 84 Employees
12.000 m² Factory Surface



Valentigney
Turnover: 20 M € / 105 Employees
18.894 m² Factory surface
Certified ISO 16949

Number of employees: **1650**

4 sites in France / **1** site in Poland / **3** sites in Argentina / **1** site in Brazil / **2** sites in Spain / **1** site in USA

Annual TO: **195 M€**

Thank you for your
attention!

